

Planta de pisos Escala.....1/75

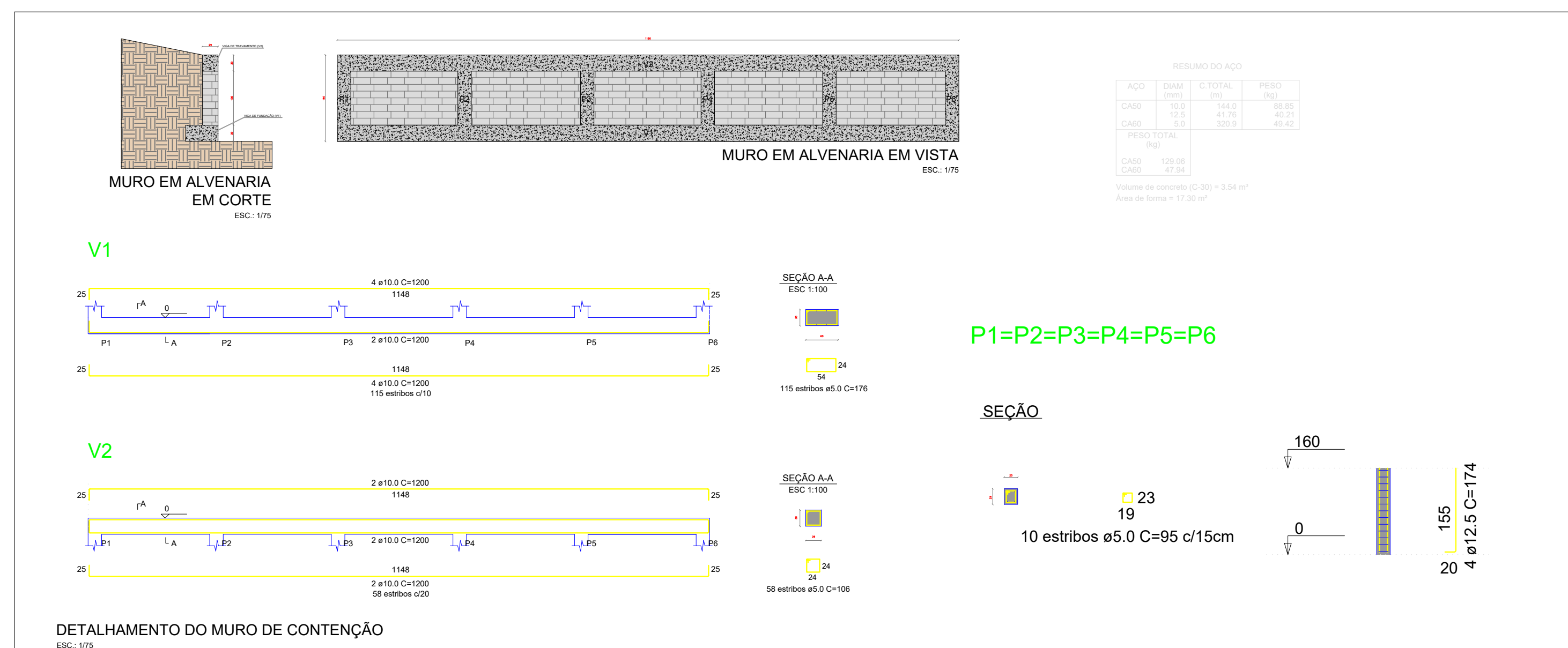

- Piso podotátil direcional, 40x40cm
- Piso podotátil alerta, 40x40cm
- Soleira em granito
- Revestimento porcelanato, cinza, 80x80cm
- Bloco intertravado de concreto, e=8,0cm
- Muro em alvenaria de blocos de concreto maciço, acabamento a vista, e=29,0cm, comp.=10,00m

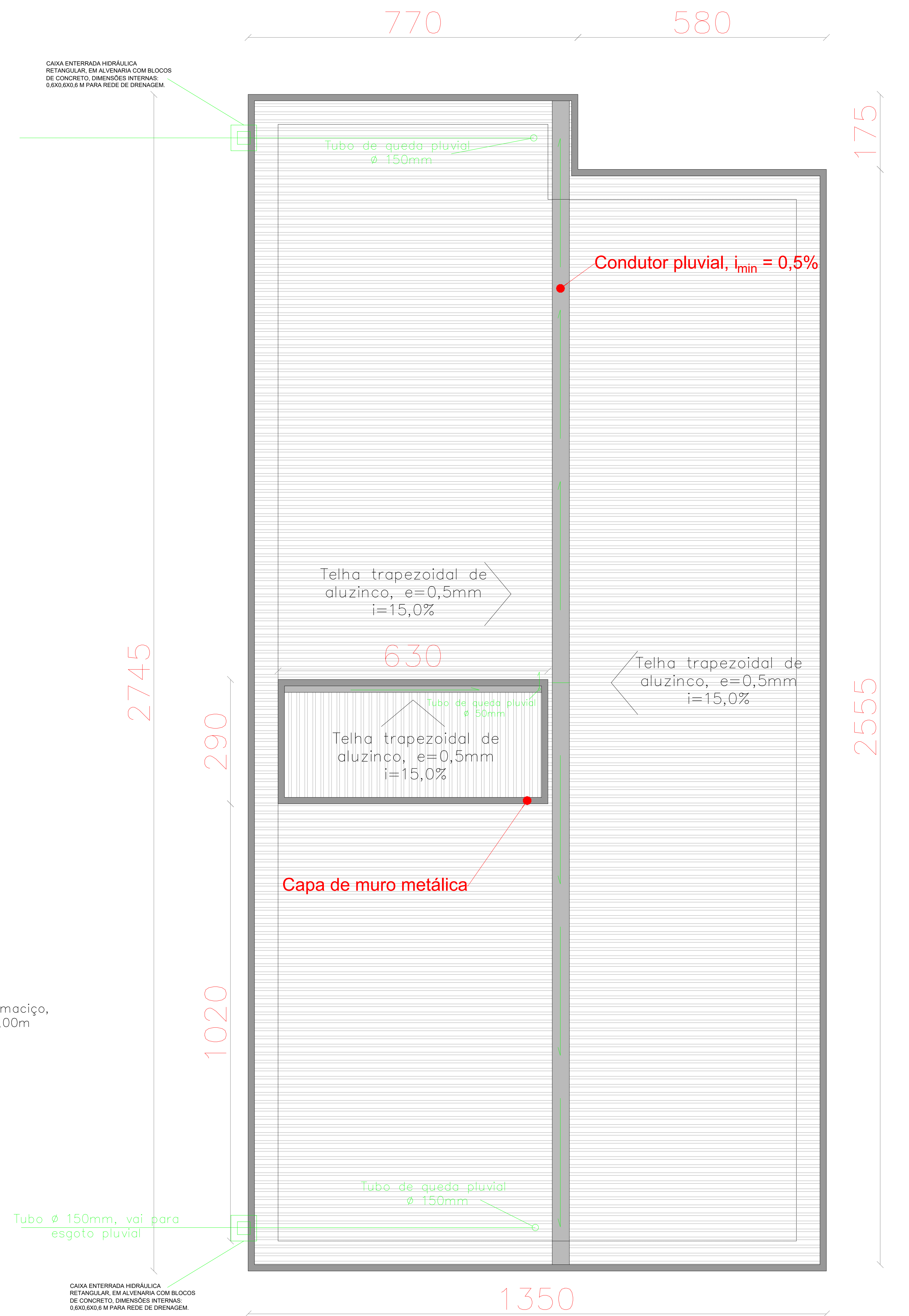
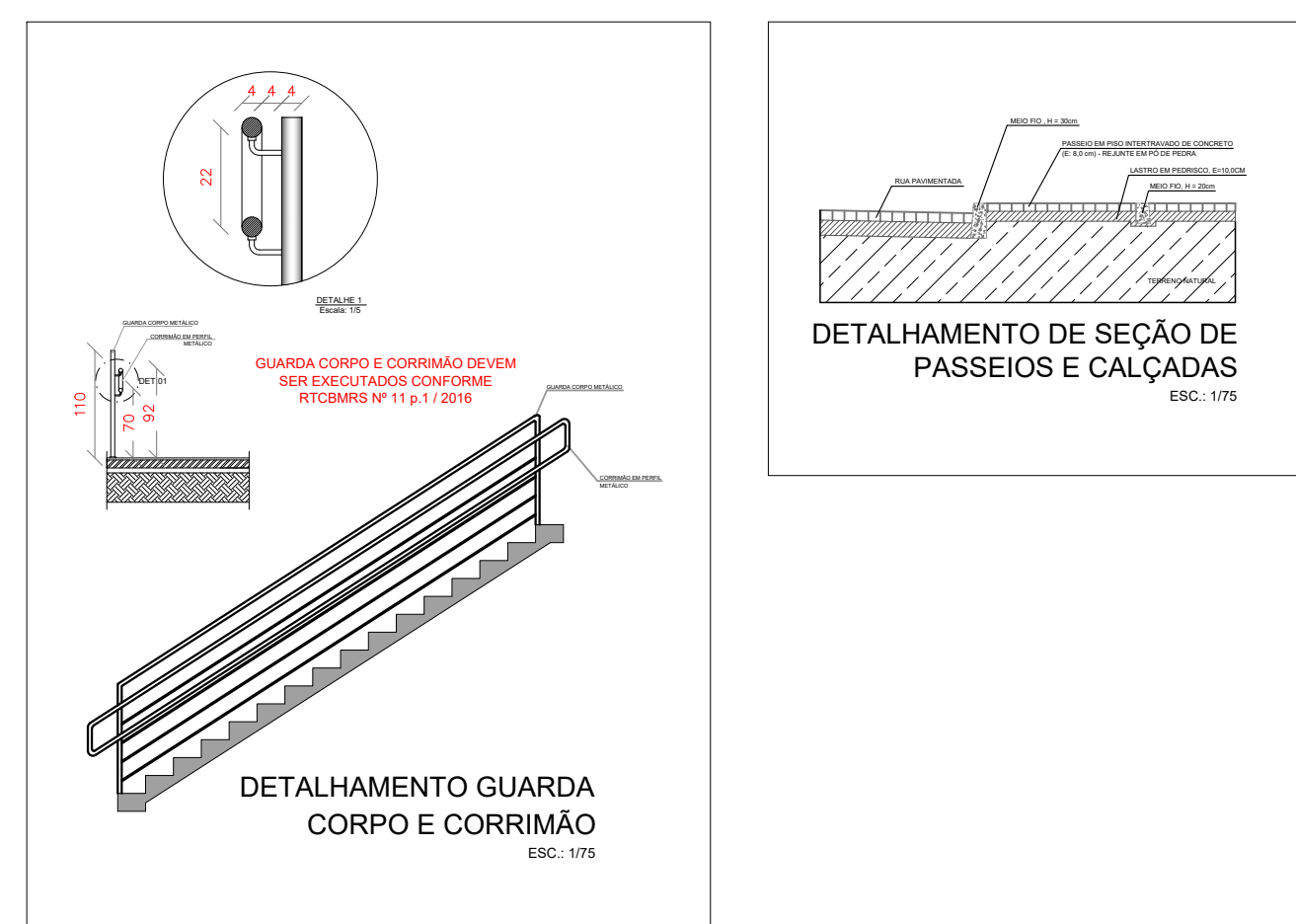

Planta Baixa Cobertura Escala.....1/50